

### Photomontage 8

**View Point:** View from the L-1641-5 local road in the townland of Tullyarvan, approximately 7.48 km west of the of the nearest turbine.

View point grid reference	(E) 635,067 (N) 934,360
Date of image taken	03.03.2020
Time of image taken	5:19pm
View point elevation	70m
Angle of Views	90° / 53.5°
View Direction (Image Centre)	107°
Horizontal extent of proposed turbines	19°
Distance to nearest proposed turbine	7.51km (T12)
Number of proposed turbines visible	7/15
Turbine Hub Height	107m
Turbine Tip Height	173m
Turbine Rotor Diameter	132m
Camera	Canon EOS 600D with 1.5x sensor
Lens	35mm prime. Equivalent zoom range 52.5mm
Tripod	Manfrotto 190X extended to approx 1.65m.
Map Licence	©Copyright of Ordnance Survey Ireland. All Rights Reserved. License No: AR 0021820

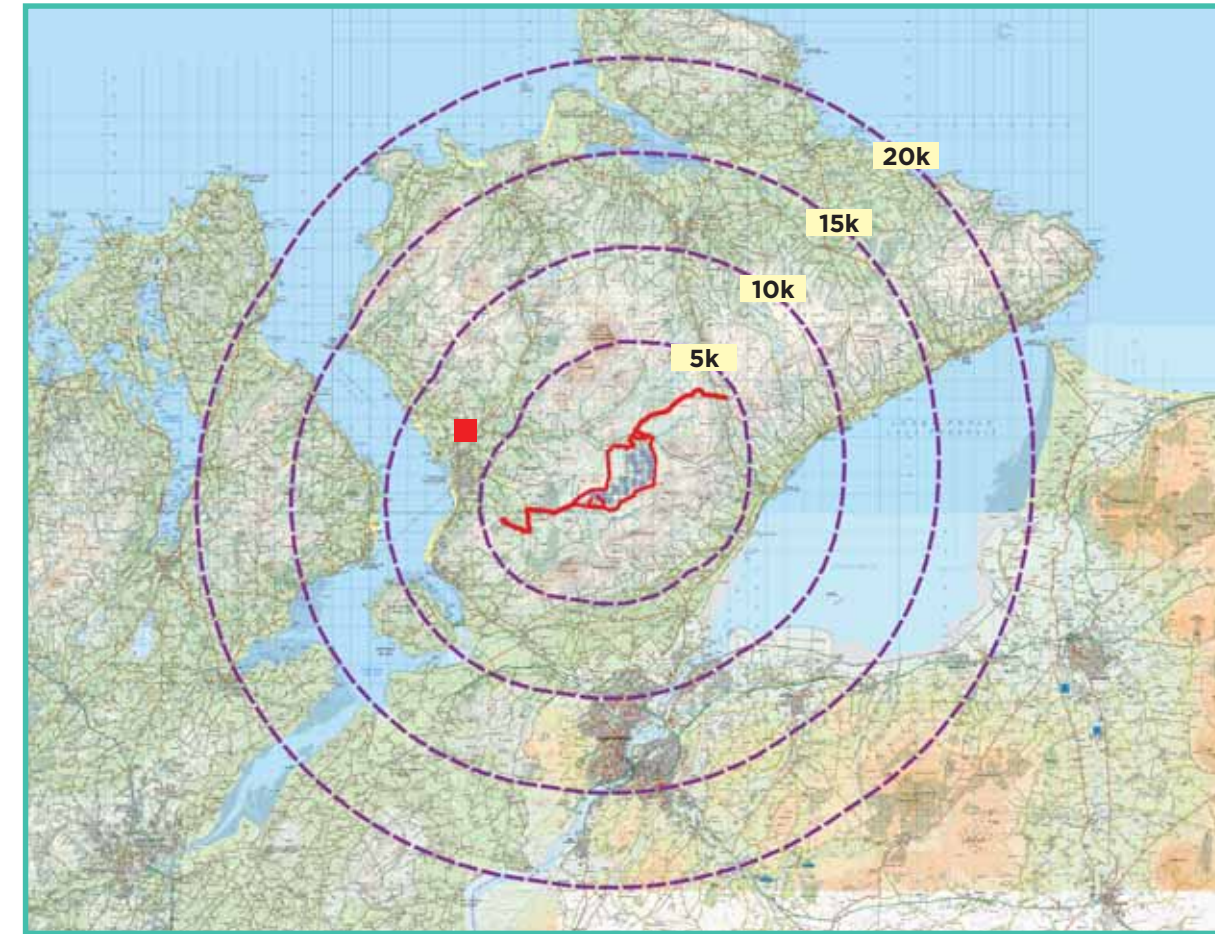

View point relative to 20km radius.



View point relative to wind farm site (EIAR Site Boundary outlined in red).



Detail of view point location.

#### Map Legend

Area shown in 90° view

Area shown in 53.5° view

View Point

EIAR Site Boundary

#### Wireframe Legend

Proposed Wind Farm in Blue

Permitted Wind Farms in Pink

Existing Wind Farms in Grey

#### Prepared by

MKO  
Planning & Environmental Consultants  
Tuam Road, Galway.

Tel: (091) 73 56 11  
E-mail: info@mkofireland.ie  
Website: www.mkofireland.ie



90° View Extent

Key Image at 120°



53.5° View Extent





Matching Wireframe

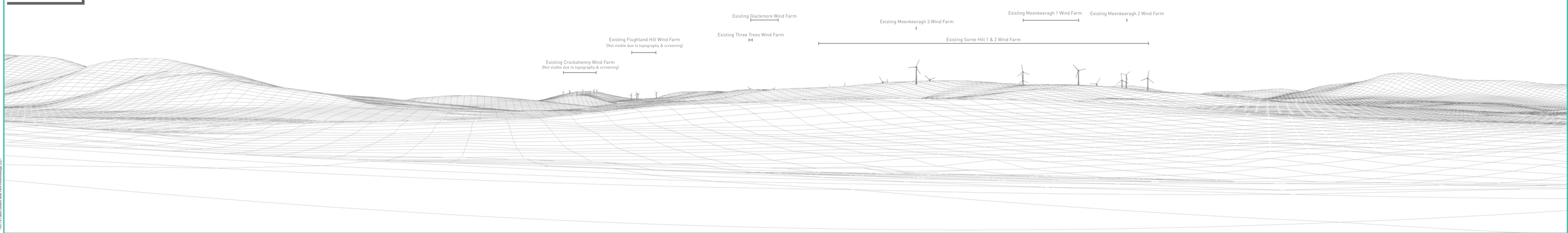



Do Nothing Scenario: Proposed development at Glenard does not proceed and permitted wind farms in the vicinity are constructed, view at 90°



Matching Wireframe

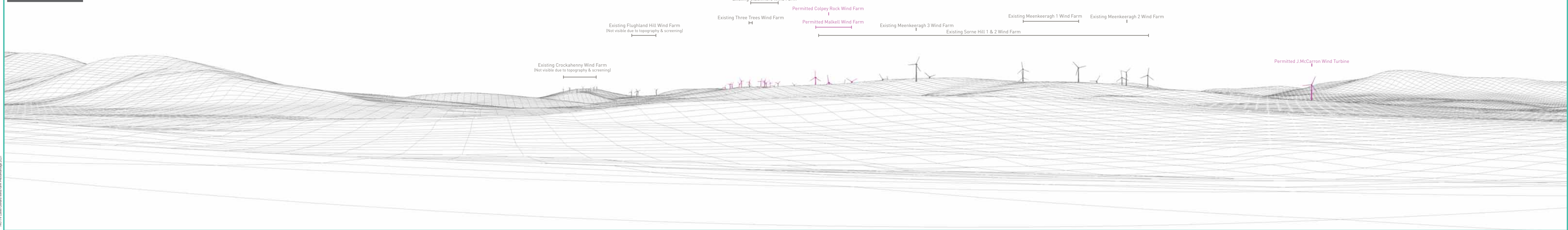



Proposed Photomontage with Cumulative at 90°



Matching Wireframe

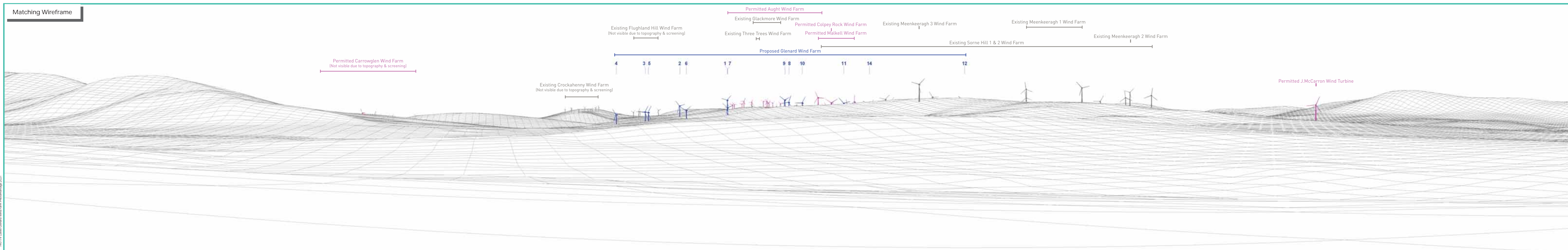



Proposed Photomontage with Cumulative at 53.5°





Matching Wireframe

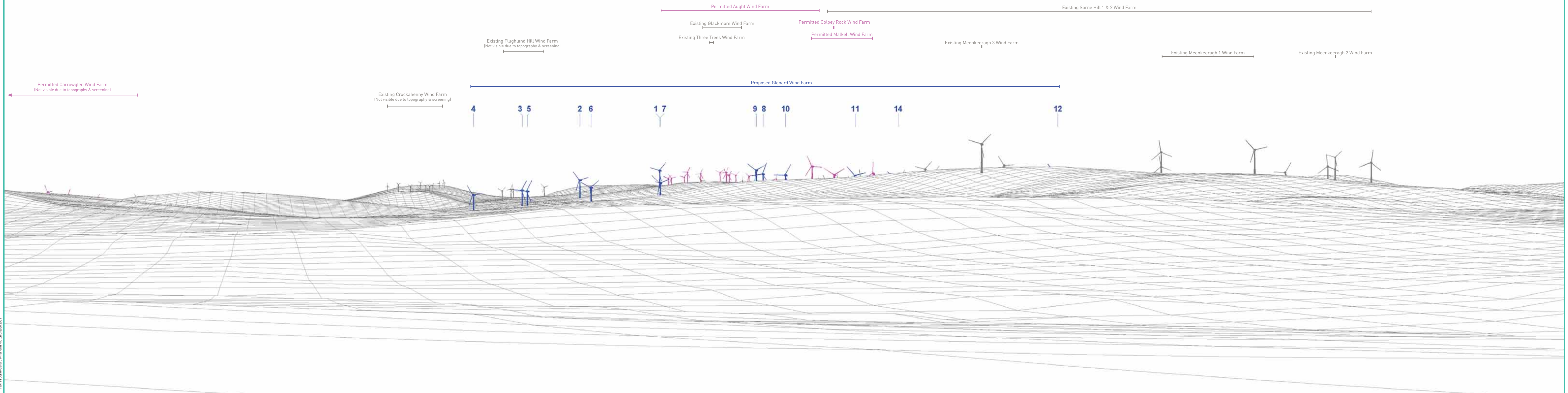

---

**VP8**

**Variation Minimum**

---



Variation Minimum with Cumulative Photomontage at 90°



Matching Wireframe

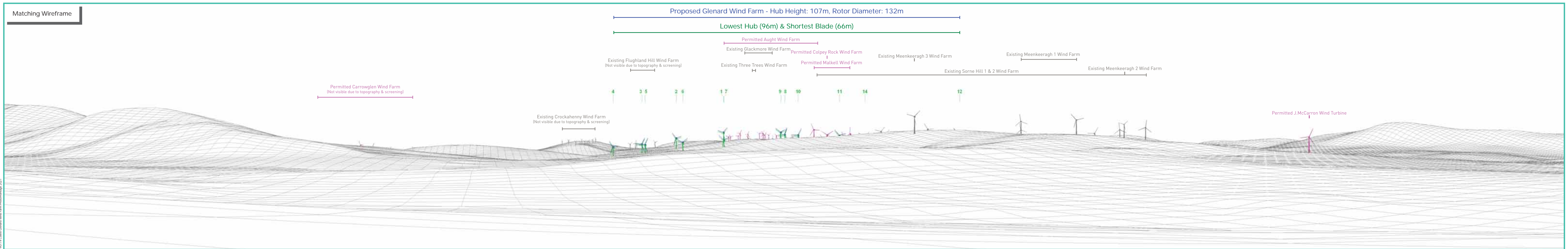



Variation Minimum with Cumulative at 53.5°





Matching Wireframe

Proposed Glenard Wind Farm - Hub Height: 107m, Rotor Diameter: 132m

Lowest Hub (96m) & Shortest Blade (66m)

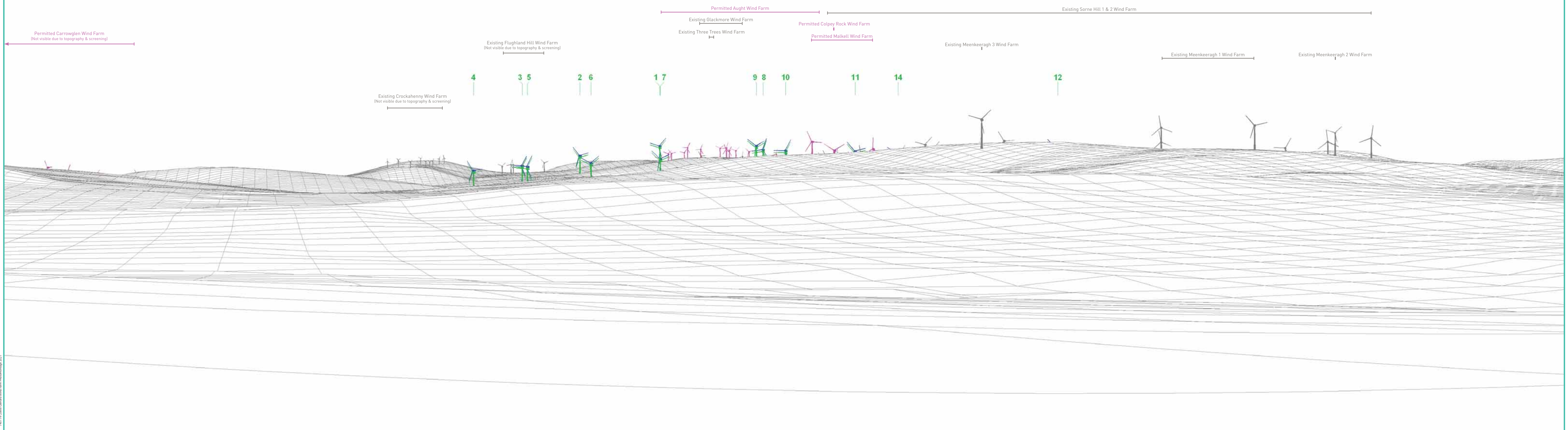



---

**VP8**  
**Variation Median**

---



Variation Median with Cumulative Photomontage at 90°



Matching Wireframe

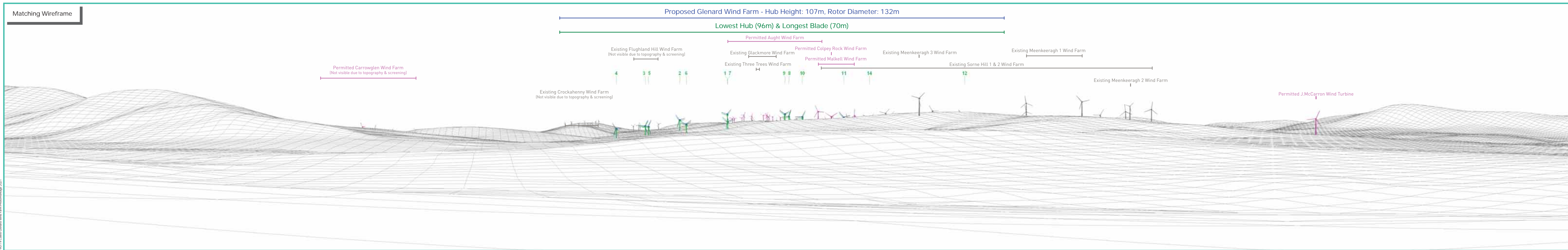



Variation Median with Cumulative at 53.5°





Matching Wireframe

Proposed Glenard Wind Farm - Hub Height: 107m, Rotor Diameter: 132m

Lowest Hub (96m) & Longest Blade (70m)

Permitted Aught Wind Farm

Existing Sorne Hill 1 & 2 Wind Farm

Existing Glackmore Wind Farm

Permitted Colpey Rock Wind Farm

Existing Three Trees Wind Farm

Permitted Malkell Wind Farm

Existing Flugland Hill Wind Farm  
(Not visible due to topography & screening)

Existing Meenkeeragh 3 Wind Farm

Existing Meenkeeragh 1 Wind Farm

Existing Meenkeeragh 2 Wind Farm

Permitted Carrowglen Wind Farm  
(Not visible due to topography & screening)

Existing Crockahenny Wind Farm  
(Not visible due to topography & screening)

4

3 5

2 6

1 7

9 8 10

11

14

12